

# Wieland

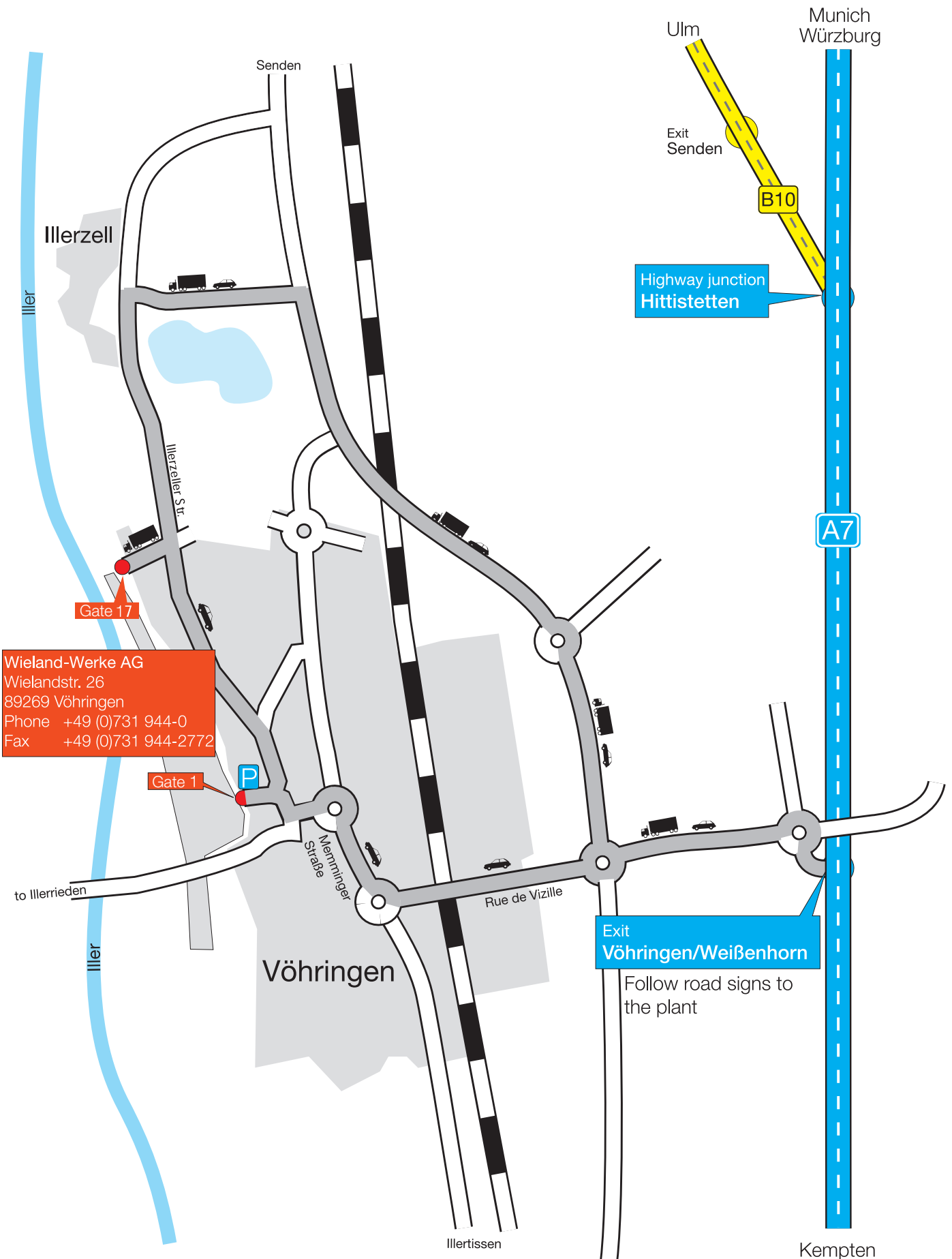

## From North (Würzburg) :

- A 7
- Exit Vöhringen (No. 123)
- Leave first roundabout to Vöhringen
- Follow road signs 'Industriegebiet Vöhringen, Wieland-Werke AG' (industrial area)
- For trucks: entry gate 17
- For cars: follow road signs 'Wieland-Werke AG PKW'
- some 3 km until Tor (gate) 1; to Vöhringen City Centre until Wielandstraße,
- then turn right, visitors' car park some 100 m on the right

## From South (Kempten) :

- A 7
- Exit Vöhringen (No. 123)
- Leave first roundabout to Vöhringen
- Follow road signs 'Industriegebiet Vöhringen, Wieland-Werke AG' (industrial area)
- For trucks: entry gate 17
- For cars: follow road signs 'Wieland-Werke AG PKW'
- some 3 km until Tor (gate) 1; to Vöhringen City Centre until Wielandstraße,
- then turn right, visitors' car park some 100 m on the right

## From East (Munich) :

- A 8
- Junction Ulm-Elchingen
- A 7 to Kempten
- Exit Vöhringen (No. 123)
- Leave first roundabout to Vöhringen
- Follow road signs 'Industriegebiet Vöhringen, Wieland-Werke AG' (industrial area)
- For trucks: entry gate 17
- For cars: follow road signs 'Wieland-Werke AG PKW'
- some 3 km until Tor (gate) 1; to Vöhringen City Centre until Wielandstraße,
- then turn right, visitors' car park some 100 m on the right

## From West (Stuttgart) :

- A 8
- Exit Ulm-West (No. 62)
- B 10 to Ulm
- B 28 to Kempten
- A 7
- Exit Vöhringen (No. 123)
- Leave first roundabout to Vöhringen
- Follow road signs 'Industriegebiet Vöhringen, Wieland-Werke AG' (industrial area)
- For trucks: entry gate 17
- For cars: follow road signs 'Wieland-Werke AG PKW'
- some 3 km until Tor (gate) 1; to Vöhringen City Centre until Wielandstraße,
- then turn right, visitors' car park some 100 m on the right

## By train:

- Vöhringen train station
- 10 minutes walk to the plant

## By aeroplane:

- Stuttgart, Munich or Memmingen airports
- Rail connection

## Alternative for passenger cars:

- A 7
- Exit Vöhringen (No. 123)
- At roundabout turn left to Vöhringen
- At roundabout straight on to Rue de Vizille
- Pass through railway underpass
- At roundabout turn right into Memminger Straße
- At roundabout turn left into Vöhlstraße
- Until Wielandstraße, then turn right to Wieland-Werke, P3
- After 150 m left, to Wieland-Werke PKW
- After some 100 m (gate) 1 Wieland-Werke, visitors' car park on the right



**Truck drivers must wear safety footwear in our plant!**